

Order No.: 5LZ971005 | GTIN (EAN): 4058352797723

Product description: SCon11,DALI2term,centCtrl,K-Bus



SITECO Connect 11 DALI-2 terminal, central control, installation type: recessed, installation location: in an electrical distributor, protection rating (complete): IP20, certification: CE, voltage: 24V, voltage type: DC, 1 x K-Bus, 2 x digital switching contact, 1 x DALI-2, packaging unit: 1 piece

IP 20 

Wt. (kg): 0.1
GTIN (EAN): 4058352797723

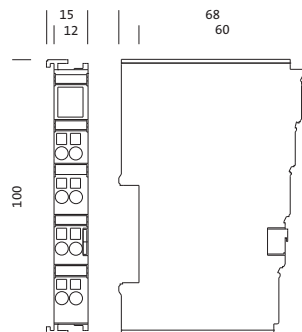

Order No.: 5LZ971005 | GTIN (EAN): 4058352797723

Detailed technical description: SCon11,DALI2term,centCtrl,K-Bus



Key data

- System family: Siteco Connect 11
- Product type: lighting management components
- Product name: SITECO Connect 11
- Order No.: 5LZ971005

Certificates, Standards

- Protection rating: IP20
- Temperature range (operation): 0..+55°C
- Certification, designation: CE

Material, Colour

- Colour specification: grey

Mounting

- Mounting method, mounting location: recessed, in an electrical distributor

Electrical connection

- Nominal voltage: 24V, DC

Dimensions, Weight

- Length: 100mm
- Width: 12mm
- Height: 68mm
- Weight: 0.1kg

Inputs

1x K-Bus

- Option: system current 55mA

2x digital switching contact

- Option: for easy commissioning

Outputs

1x DALI-2

- Connection: plug-in terminal, 2x 2-pole, max. 2.5mm²
- Protocol: according to current DALI-2 standard
- Feature: integrated power supply (250mA per DALI line)

Order No.: 5LZ971005 | GTIN (EAN): 4058352797723

Dimensions: SCon11,DALI2term,centCtrl,K-Bus

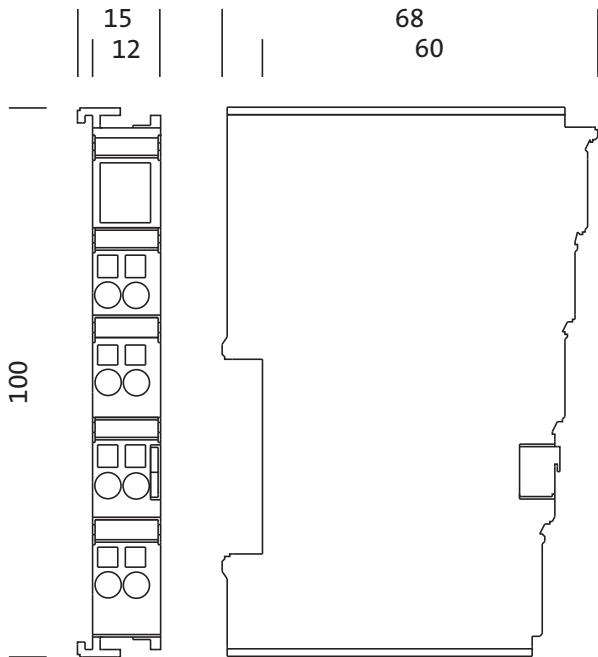

It is mandatory that the assembly instructions must be observed when planning and installing the electrical installation (to be found at www.siteco.de)
Tolerances related to thermal, electrical and photometric data according to IEC 62722
Issued 29.09.2023 - Modifications and errors subject to change - Ensure that you always use the latest version -