

Order No.: 51MR36GD0321B | **GTIN (EAN):** 4058352881606

Product description: Round21M,opal,dir/ind,6790lm830,DA2,bk



Round 21 M, wall and ceiling luminaire, primary optical cover: cover, of PMMA, opal, light emission: direct/indirect distribution, primary light characteristic: symmetric, installation type: suspended mounting, surface-mounted, LED, rated luminous flux: 6.790lm, luminous efficacy: 124lm/W, light colour: 830, colour temperature: 3000K, with terminal, 5-pole, mains connection: 230V, AC, 50/60Hz, rated input power: 55W, housing, of aluminium, coated, black, diameter: 600mm, height: 62mm, protection rating (complete): IP40, insulation class (complete): insulation class I (protective earthing), certification: CE, impact resistance: IK04, permissible operating ambient temperature: -10..+35°C, packaging unit: 1 piece

IP 40  

Lamps:	LED
Wt. (kg):	5.8
GTIN (EAN):	4058352881606

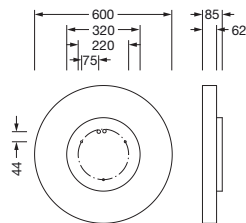

Order No.: 51MR36GD0321B | GTIN (EAN): 4058352881606

Detailed technical description: Round21M,opal,dir/ind,6790lm830,DA2,bk



Key data

- Product type: wall and ceiling luminaire
- Product name: Round 21 M
- Order No.: 51MR36GD0321B

Lighting technology | Lamps | Control gear

Component 1

Lighting technology:

- Cover: cover, opal
- Beam angle: 105°
- Symmetry: symmetric
- Light emission: direct/indirect distribution
- UGR viewing direction along longitudinal luminaire axis: ≤ 22
- UGR viewing direction along lateral luminaire axis: ≤ 22

Lamps:

- Lamps: with LED
- Rated luminous flux: 6790lm
- Luminous efficacy: 124lm/W
- Colour temperature: 3000K
- Colour rendering index: CRI > 80
- Light colour: 830
- SDCM (Standard Deviation of Colour Matching): MacAdam ≤ 3 SDCM (initial)
- Rated input power: 55W

Operating device:

- Control: DALI 2

Certificates, Standards

- Protection rating: IP40
- Insulation class: insulation class I (protective earthing)
- Impact resistance: IK04
- Temperature range (operation): -10..+35°C
- Certification, designation: CE

Material, Colour

- housing: aluminium, coated, black
- Colour specification: black
- Cover: cover of PMMA

Mounting

- Mounting method, mounting location: suspended mounting, surface-mounted, to the ceiling, to the wall
- Arrangement: single arrangement

Electrical connection

- Connection: terminal, 5-pole
- Nominal voltage: 230V, 50/60Hz, AC

Dimensions, Weight

- Diameter: 600mm
- Height: 62mm
- Weight: 5.8kg

Order No.: 51MR36GD0321B | GTIN (EAN): 4058352881606

Dimensions: Round21M,opal,dir/ind,6790lm830,DA2,bk

